

# Instructions to use an Anti-wolf collar

Français

Merci d'avoir acheté un collier anti-loup.

La notice d'utilisation est disponible ci-dessous ou sur cette page web ([www.collier-antiloup.com/sav-maintenance](http://www.collier-antiloup.com/sav-maintenance))

English: Thank you for purchasing a wolf collar.

The instruction manual is available in your language on this web page ([www.collier-antiloup.com/sav-maintenance](http://www.collier-antiloup.com/sav-maintenance))

Italiano : Grazie per aver acquistato un collare per lupi.

Le istruzioni per l'uso sono disponibili nella vostra lingua su questa pagina web

([www.collier-anti-loup.com/sav-maintenance](http://www.collier-anti-loup.com/sav-maintenance))

Español : Gracias por comprar un collar de lobo.

El manual de instrucciones está disponible en su idioma en esta página web

([www.collier-anti-loup.com/sav-maintenance](http://www.collier-anti-loup.com/sav-maintenance))

Deutsch : Vielen Dank, dass Sie ein wolfssicheres Halsband gekauft haben.

Die Gebrauchsanweisung ist in Ihrer Sprache auf dieser Webseite ([www.collier-antiloup.com/sav-maintenance](http://www.collier-antiloup.com/sav-maintenance))

## Presentation of the anti-wolf collar:

### What is the AWC?

The Anti-Wolf Collar, AWC, is an exceptional device to protect your herds of sheep, goats, cattle, or horses against wolf attacks.

It is an anti-predator repellent, with lights and ultrasounds.

### How does it work?

The collar should be placed around the neck of your animals.

It constantly monitors the behavior of your animals. For example, when your animals flee from the presence or attack of wolves, the collar activates a powerful ultra-high frequency alarm and powerful strobe lights. As the predator approached to hunt, the surprise effect is total. Repellents will disrupt, disorient and irritate predators. The attack is halted, and the wolves will flee, prompting them to return to their natural prey.

The equipment ratio is 1 collar for at least 8 sheep and 1 collar for 5 cattle.

There are 3 types of collars, adjusted according to the animals: one for sheep/goats, one for horses, and one for young cattle.

### Is it effective?

This type of collar is widely used in South Africa to protect sheep from jackals, lynxes, and leopards. More than 5000 collars are in place there. The anti-wolf collar has been successfully tested in France on various farms and pastures.

**SARL CICAL**

01170 Gex -France / +33 (0)7 82 23 91 12 / [cyril.gautreau@collier-anti-loup.com](mailto:cyril.gautreau@collier-anti-loup.com)

Siren : 893238055 – RCS : 893 238 055 RCS Bourg-en-Bresse

Over 5 years of tests, the batches equipped with collars (11 sets of 20 to 80 animals) were attacked only once, and the nearby non-equipped control batches went through more than 20 attacks, with more than 20 animals killed against one. It has also been tested in Germany with the same success.

Scientific studies show that using repellent, mobile tools, which emit lights and sounds or ultrasounds unpredictably, by random combinations, when a predator approaches or attacks, are the keys to effectively scaring away a predator and preventing habituation. The anti-wolf collar presents all of these functions.

It is a very effective tool.

### **Still not familiar yet?**

The wolf collar has a powerful speaker. It diffuses an ultrasound oscillating in many frequencies to emit a very aggressive sound. It has several colors of LED.

It has different programs of light flashing and several durations of activation. The whole is diffused randomly. More than 200 combinations are available to avoid any habituation.

### **Does it scare dogs?**

These collars have been tested on driving and protection dogs. Some dogs do not react, and others do and move back. They then adapt to these ultrasounds.

### **And maintenance?**

The collars are robust, reliable, and waterproof, with a battery that lasts over a year.

Maintenance is reduced to the simplest. You just need to change the collar battery once a year, at the end or beginning of the grazing season.

### **Why do we offer this tool?**

The goal is to allow you to produce and raise your animals, without wasting time protecting your herds. It's not your job; it's the AWCs.

For this reason, we have built an efficient tool that is simple to set up, reliable, and requires little maintenance.

What we want is your peace of mind. Protecting your animals is no longer a problem; attacks and predators are non-existent.

### **Place the anti-wolf collar around the animal's neck**

See the video below, or by flashing this QR-code  
<https://www.youtube.com/shorts/3b1yKUKQb6Q>



The collar comes with a battery connected and ready to use. Activate the device before fitting it to the animal by vigorously shaking the collar 2 to 3 times, up and down and left to right, for a sheep/goat or horse collar, or by shaking it gently for a collar cattle.

### **SARL CICAL**

01170 Gex - France / +33 (0)7 82 23 91 12 / [cyril.gautreau@collier-anti-loup.com](mailto:cyril.gautreau@collier-anti-loup.com)

Siren : 893238055 – RCS : 893 238 055 RCS Bourg-en-Bresse

The LED lights will flash for about 20 seconds, and a slight sound will be heard. The device will then return to standby mode. The collar is received with a strap that must be positioned on the animal, as it appears when receiving your AWCs.



Secure the strap around the animal's neck, adjusting the wide Velcro strip along its entire length. Tighten the 25mm black strap by passing it through the buckle, then the next first loop.

The collar should be snug, neither too tight nor too loose. The box is too tight if it is on the side of the animal's neck. Check and adjust the collar monthly for growing animals.

### **Maintenance**

The maintenance of anti-wolf collars is intended to be simple and autonomous. Anti-Wolf collars have a battery that lasts about a year. To keep the anti-wolf collar working, you only need to change the AWC battery once a year.

To purchase it, go to the website store ([www.collier-anti-loup.com](http://www.collier-anti-loup.com)) and order the number of batteries corresponding to the number of collars you have.

You can also order new straps online.

If you would like support and send us your collars so we can change the batteries and straps, contact us at [contact@collier-anti-loup.com](mailto:contact@collier-anti-loup.com), and we will send you an estimate for this annual maintenance. After the agreement and payment of the invoice, you can send us your AWCs; we will update them according to the desired services and send them back to you.

### **Change the battery**

See the video below, copy this link on a web browser, flash this QR-code, or type on a search engine: How to change anti-wolf collar battery.

<https://www.youtube.com/watch?v=1tsHEueomjA>

**SARL CICAL**

01170 Gex - France / +33 (0)7 82 23 91 12 / [cyril.gautreau@collier-anti-loup.com](mailto:cyril.gautreau@collier-anti-loup.com)

Siren : 893238055 – RCS : 893 238 055 RCS Bourg-en-Bresse



The replacement battery is notably available for purchase on the website [www.collier-anti-loup.com](http://www.collier-anti-loup.com). It is supplied with a connector.

Start by removing the strap from the case.



Before opening the case, clean the outside of your AWC with a damp cloth or sponge, or brush it.

Unscrew the four captive screws from the case cover. Gently lift the battery cover. Disconnect the battery from the device by gently pressing the small locking button and unlocking the connector. Do not pull on the wires to disconnect the battery from its connector; the connector must be disconnected gently with simple pressure.

**After opening, there may be some dust in the cover containing the gasket or around the gasket, and also on the rib of the case that crushes the gasket. Scrub gently with a soft brush or toothbrush to remove any impurities. It is very important for your collar to be watertight that the closing areas of the case and lid are kept clean.**

**SARL CICAL**

01170 Gex - France / +33 (0)7 82 23 91 12 / [cyril.gautreau@collier-anti-loup.com](mailto:cyril.gautreau@collier-anti-loup.com)

Siren : 893238055 – RCS : 893 238 055 RCS Bourg-en-Bresse

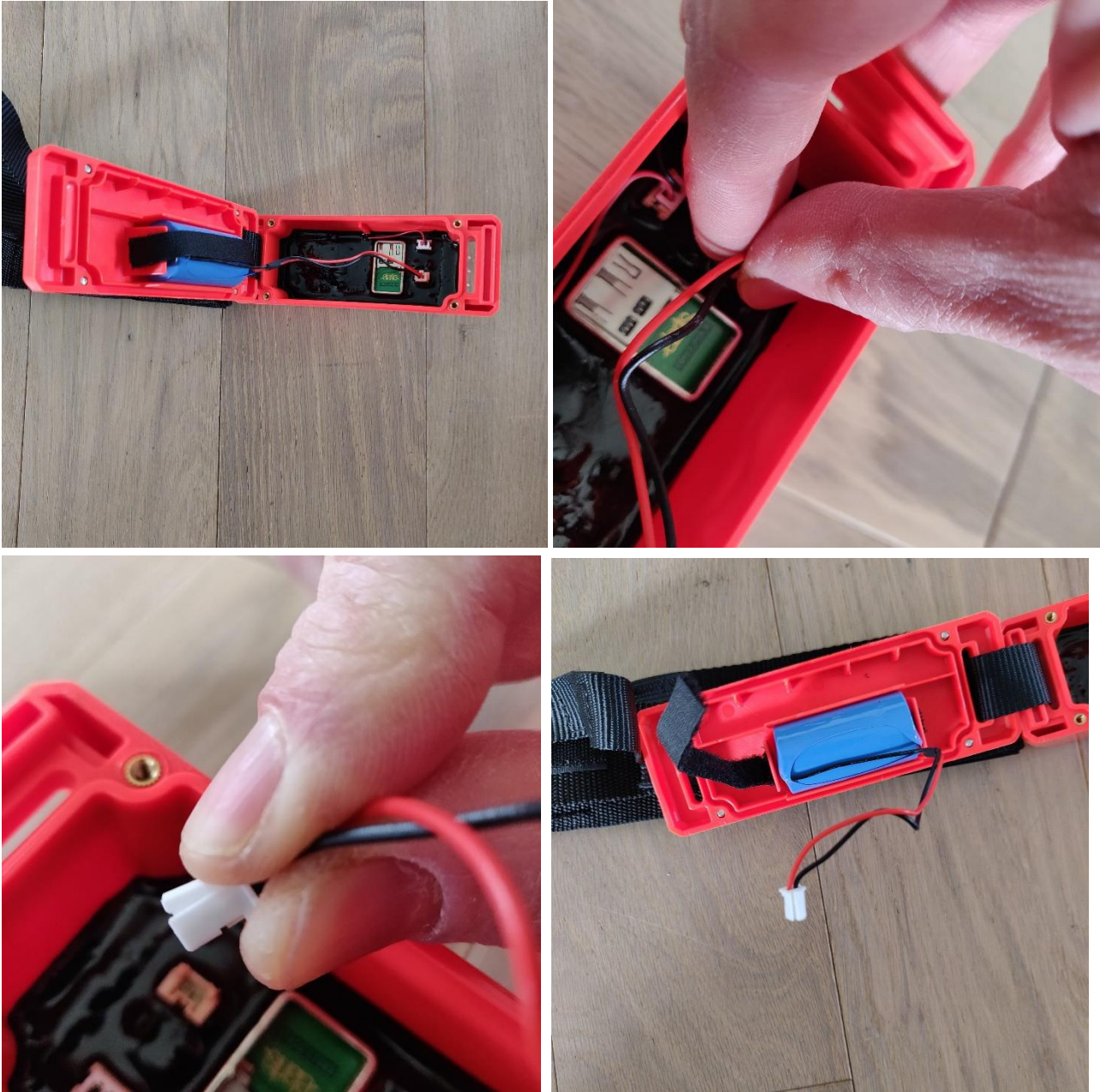

Remove one side of the battery compartment, locking the Velcro strip. Next, remove the battery from the cover. Insert the new battery into the slot provided on the surface. Replace the battery compartment and lock the hook-and-loop strap. Connect the battery to the device by gently plugging the battery connector into the device. You should hear a small locking click. The LED lights will activate when the battery connects to the device and flash for a few seconds. A slight hum will also be heard. Close the device cover. Tighten the four cover screws **all the way**. Activate the device by shaking vigorously from top to bottom, and from left to right, for a sheep/goat or horse collar or by shaking it gently for a cow collar. The LED lights will flash for approximately 20 seconds, and a slight buzzing sound will be heard. The collar will then be reset and ready to use. The device will then return to standby mode. Put the strap back in the loops of the case and the belt. Next, put the strap back on the animal. To find out how to put the strap back on, see the chapter on “putting on or changing the strap.”

#### SARL CICAL

01170 Gex - France / +33 (0)7 82 23 91 12 / [cyril.gautreau@collier-anti-loup.com](mailto:cyril.gautreau@collier-anti-loup.com)

Siren : 893238055 – RCS : 893 238 055 RCS Bourg-en-Bresse

**Replace or change the strap :**

See the video below, or by copying the link on a web browser, scan this QR-code, or type on a search engine: How to put on a wolf collar strap

<https://www.youtube.com/shorts/UBJwW2LJAHo>

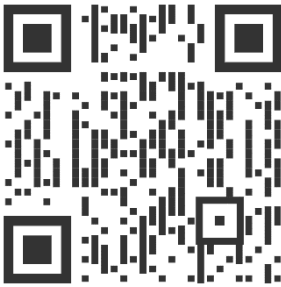

Lay the collar flat on the strap.

Slide the 25mm strap through the slots in the case. The 25mm strap must pass over the cover. Push the box to the sewn end of the 25mm black strap. A scratch strip must be on the lid of the box. Assemble the female scratch strip with the male scratch strip of the 50mm strap.



Pass the strap through the first black loop. Next, assemble a scratch band between the 25mm and 50mm straps. Pass the 25mm strap through the other circles. Next, pass the 25mm strap through the buckle. Tighten and pass the 25mm strap through the next loop to obtain perfect strap locking. If the gray or blue colored band goes badly through the buckle, pull towards either with the thumb at the end of the clip and pull the colored bar down, and it will pass.

**SARL CICAL**

01170 Gex - France / +33 (0)7 82 23 91 12 / [cyril.gautreau@collier-anti-loup.com](mailto:cyril.gautreau@collier-anti-loup.com)

Siren : 893238055 – RCS : 893 238 055 RCS Bourg-en-Bresse



#### Other Recommendation :

We recommend wiping the LED lights every 3 months with a cloth for optimal performance.

#### After-sales service for anti-wolf collars

Anti-Wolf collars are sturdy and reliable. They are also waterproof. As the regulations indicate, they are guaranteed for two years. However, in case of a functional problem, we invite you to refer to Article 10 of our General Conditions of Sale (GCS) to assess whether this possible problem falls within the guarantees.

If the anti-wolf collar doesn't work, ensure that the batteries remain intact before sending us your AWC for repair. Then, replace the battery with a new one or one from a working collar and test its operation.

To have your AWC repaired under its guarantee, we invite you to contact us by email at [contact@collier-anti-loup.com](mailto:contact@collier-anti-loup.com)

#### Technical information

The anti-wolf collar is made in France. It has a CE marking.

CAL by SARL CICAL -  
01170 GEX - France



Model N° : 0125

IP55

Battery : 3,6V  9Ah

Made in France



PA/PE

Recyclable device. Please do not throw it in the trash but in a specific sorting bin for electronic devices.

**SARL CICAL**

01170 Gex - France / +33 (0)7 82 23 91 12 / [cyril.gautreau@collier-anti-loup.com](mailto:cyril.gautreau@collier-anti-loup.com)

Siren : 893238055 - RCS : 893 238 055 RCS Bourg-en-Bresse

  
**Contacts, information :**

[www.collier-anti-loup.com](http://www.collier-anti-loup.com)

Mail : [contact@collier-anti-loup.com](mailto:contact@collier-anti-loup.com)

Phone : +33(0)7 82 23 91 12

**SARL CICAL**

01170 Gex - France / +33 (0)7 82 23 91 12 / [cyril.gautreau@collier-anti-loup.com](mailto:cyril.gautreau@collier-anti-loup.com)

Siren : 893238055 – RCS : 893 238 055 RCS Bourg-en-Bresse